

Features: (typical values)

- QORVO QPA0106 IN SMA-F
- Output Power..... +42 dBm
- Gain +32 dB
- Internal DC blocking capacitors.
- Unconditional Stability
- Requires +22V and -5V Supplies
- Requires heat sink
- All-purpose GaN driver
- Radar
- Electronic Warfare
- Optional: Available in Single +30V Supply

**1000-6000 MHz
Wideband 18W GaN Amplifier**

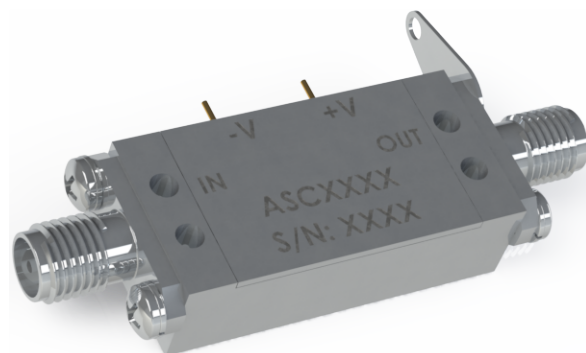

Maximum Ratings

Operating Base Temp. -30°C to +70°C
 Storage temperature -55°C to +125°C
 DC Operating Voltage +40V/-5V
 RF Input Power..... +30 dBm. Max

Specifications @ Tcase = 25°C, Vcc = +22V and -5V, 50 ohm systems unless otherwise noted.

Parameter	Typical Conditions	Min Value	Max Value	Units
Frequency Range		1000	6000	MHz.
Gain	31	30		dB.
Gain Flatness	±1.5		±2.0	dB.
Input VSWR – 50 OHMS	2.2:1			-
Output VSWR – 50 OHMS	2.2:1			-
PAE @ Pin =19dbm	40			%
3 rd Oder IM @ 30dbm	27			dBc
2 nd Harmonics @ Pin = 19dbm	26			dBc
Output Power	42			dBm.
INPUT/OUTPUT Connector SMA-F				.
Supply Current Idq @ +22 Drain Voltage and -5V Gate	1022			mA

TYPICAL GAIN, INPUT, AND OUTPUT RETURN LOSS PLOTS @ 25°C

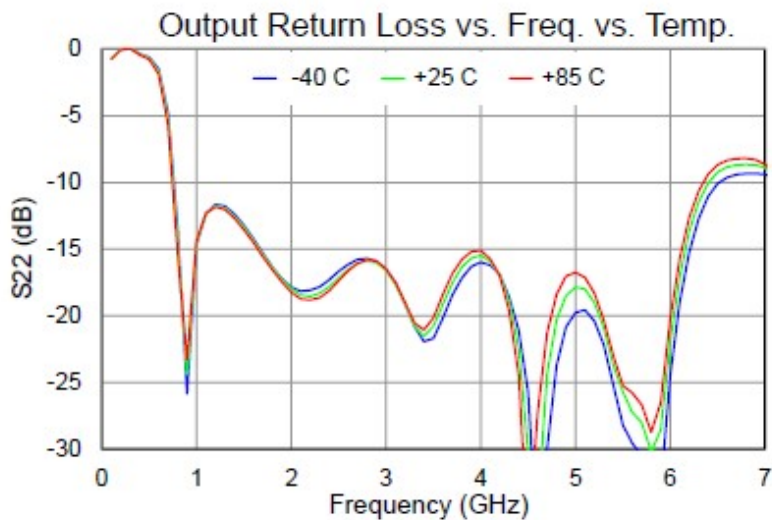
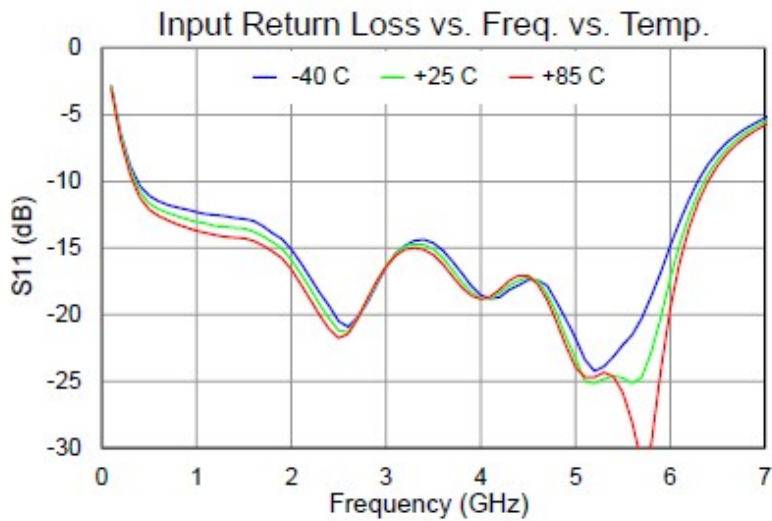
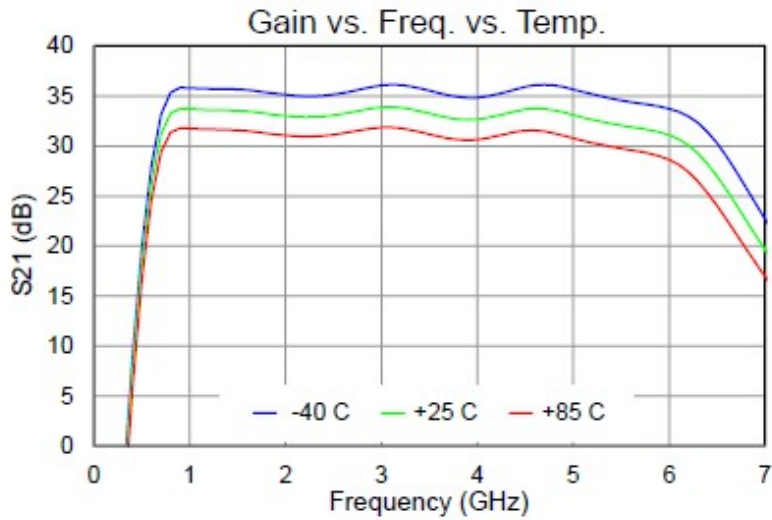

TYPICAL OUTPUT POWER PERFORMANCE @ 25°C

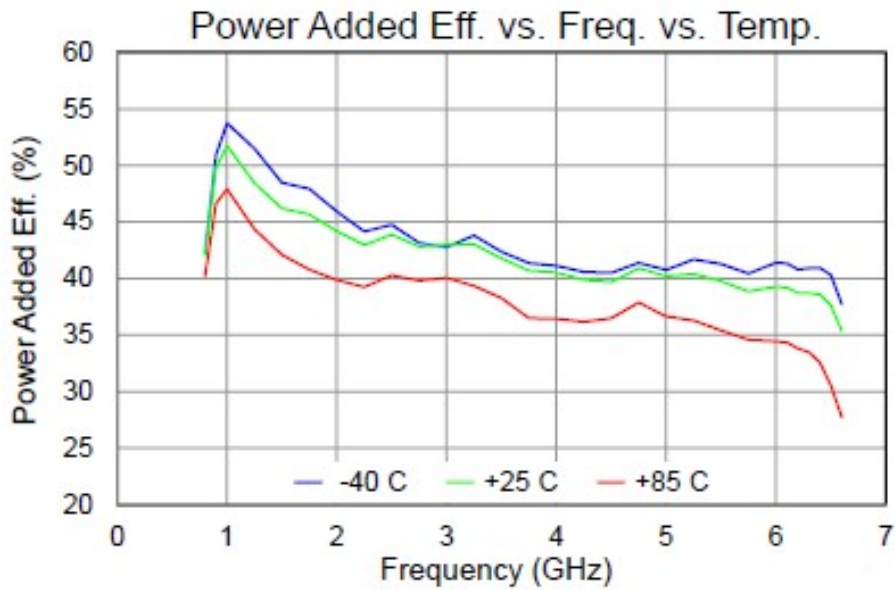
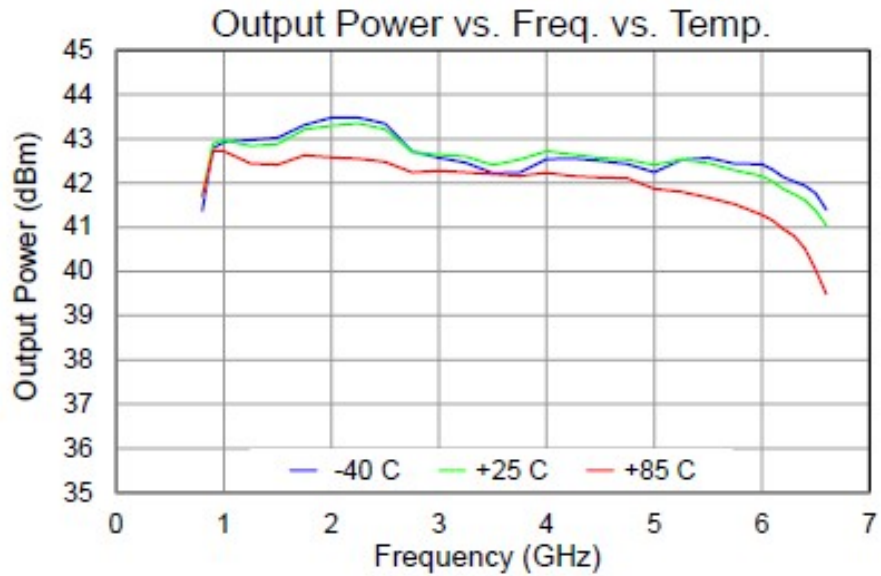

OUTLINE

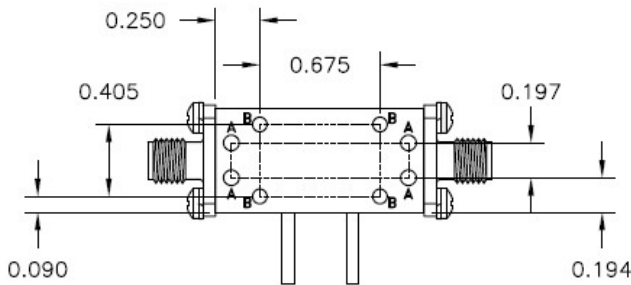
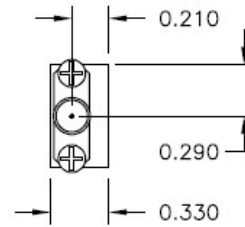
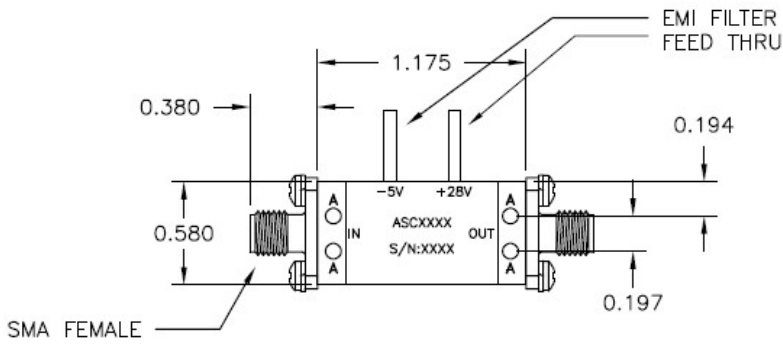
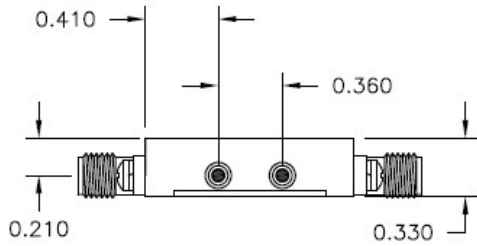

HOLE CHART	
HOLE	DESCRIPTION
A	∅0.090 THRU
B	#2-56-UNC-2B, .100 DP MIN

OPTIONAL FOR HOUSING SINGLE +30V SUPPLY

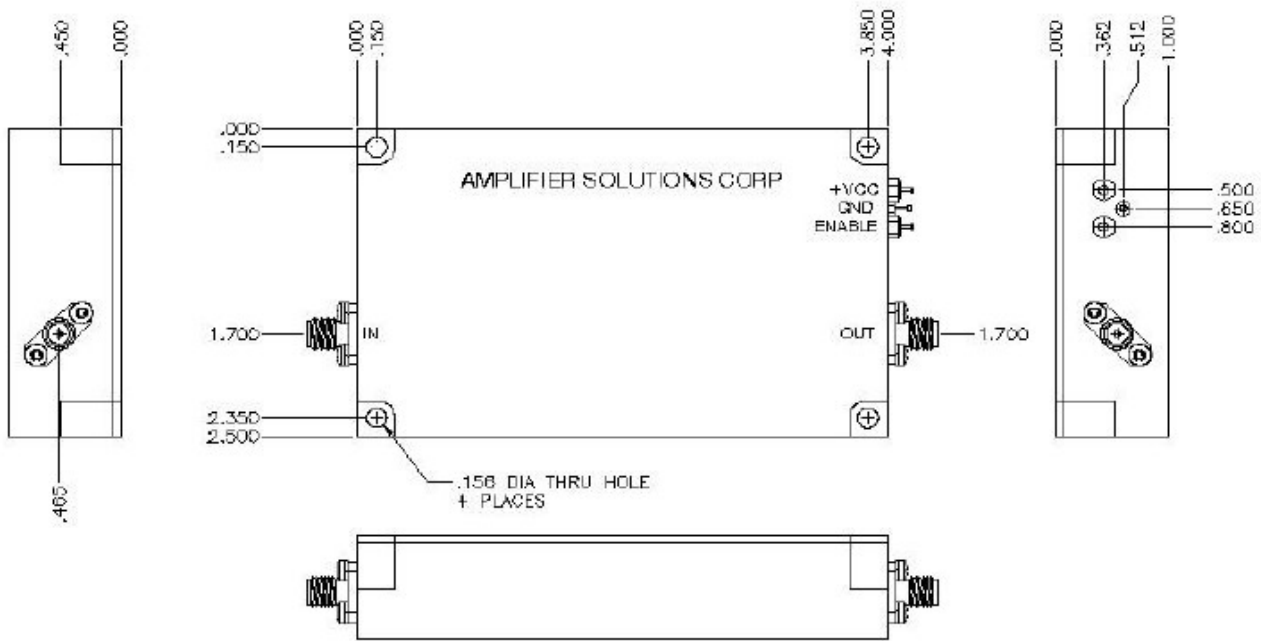

FUNCTIONAL BLOCK DIAGRAM

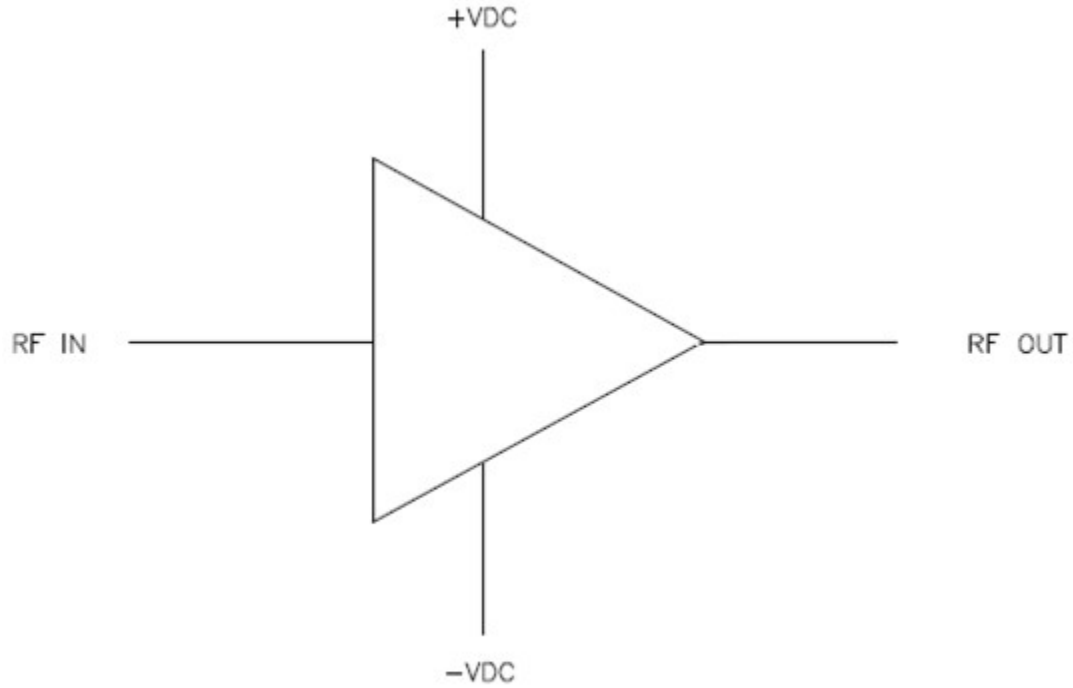

NO EXTERNAL COMPONENT REQUIRED